

【MC-02】

ISO 4401-AB-03-4-A, CETOP 03, NG6, NFPA-D03

※SPECIFICATION

MODEL	MAX. OPER. PRES. Bar(PSI)	MAX. FLOW (ℓ/min)	WEIGHT (Kg)
MC-02-P	210(3045)	40	1.2
MC-02-T			
MC-02-A/B			
MC-02-W			

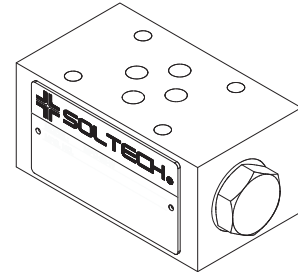

※GRAPHIC SYMBOL

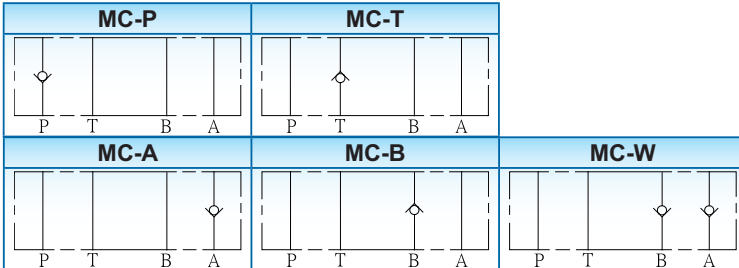

※MODEL NUMBER DESIGNATION

MC	02	A	1	(90)
SERIES NO.	02: NG6	FUNCTION PORT A: "A" PORT B: "B" PORT W: "A&B" PORT P: "P" PORT T: "T" PORT	CRACKING PRESSURE (Kg/cm ²) 1: 0.5 2: 2.5 3: 4	OMIT: DIN 912 BOLTS 90: UNC BOLTS (NORTH AMERICA)

※DIMENSIONS

MC-02-A/P/T: The handler is at "A" side
MC-02-B: The handler is at "B" side
MC-02-W: The handler is at "A&B" side

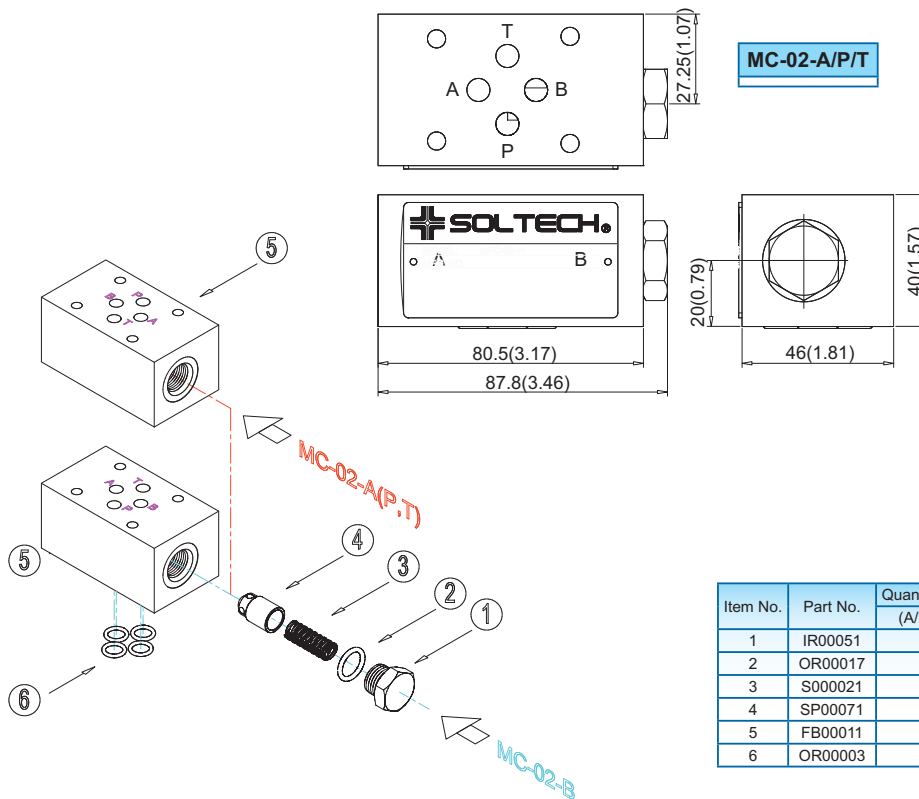

Item No.	Part No.	Quantity(PCs) (A/B/P/T)
1	IR00051	1
2	OR00017	1
3	S000021	1
4	SP00071	1
5	FB00011	1
6	OR00003	4

UNIT: M.M.(INCH)

【MC-03】

ISO 4401-AC-05-4-A, CETOP 05, NG10, NFPA-D05

※SPECIFICATION

MODEL	MAX. OPER. PRES. Bar(PSI)	MAX. FLOW (ℓ/min)	WEIGHT (Kg)
MC-03-P	210(3045)	80	2.7
MC-03-T			
MC-03-A/B			
MC-03-W			

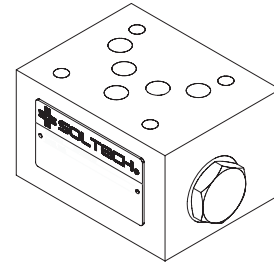

※GRAPHIC SYMBOL

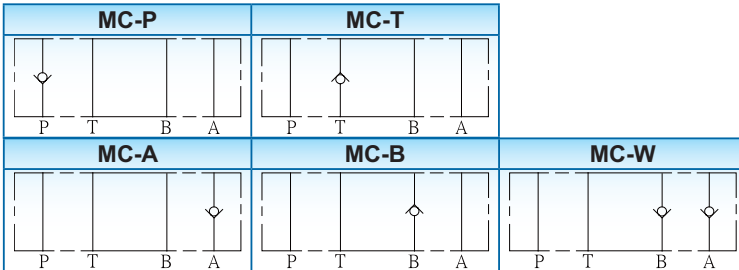

※MODEL NUMBER DESIGNATION

MC	03	A	1	(90)
SERIES NO.	03: NG10	FUNCTION PORT A: "A" PORT B: "B" PORT W: "A"&"B" PORT P: "P" PORT T: "T" PORT	CRACKING PRESSURE (Kg/cm ²) 1: 0.5 2: 2.5 3: 4	OMIT: DIN 912 BOLTS 90: UNC BOLTS (NORTH AMERICA)

※DIMENSIONS

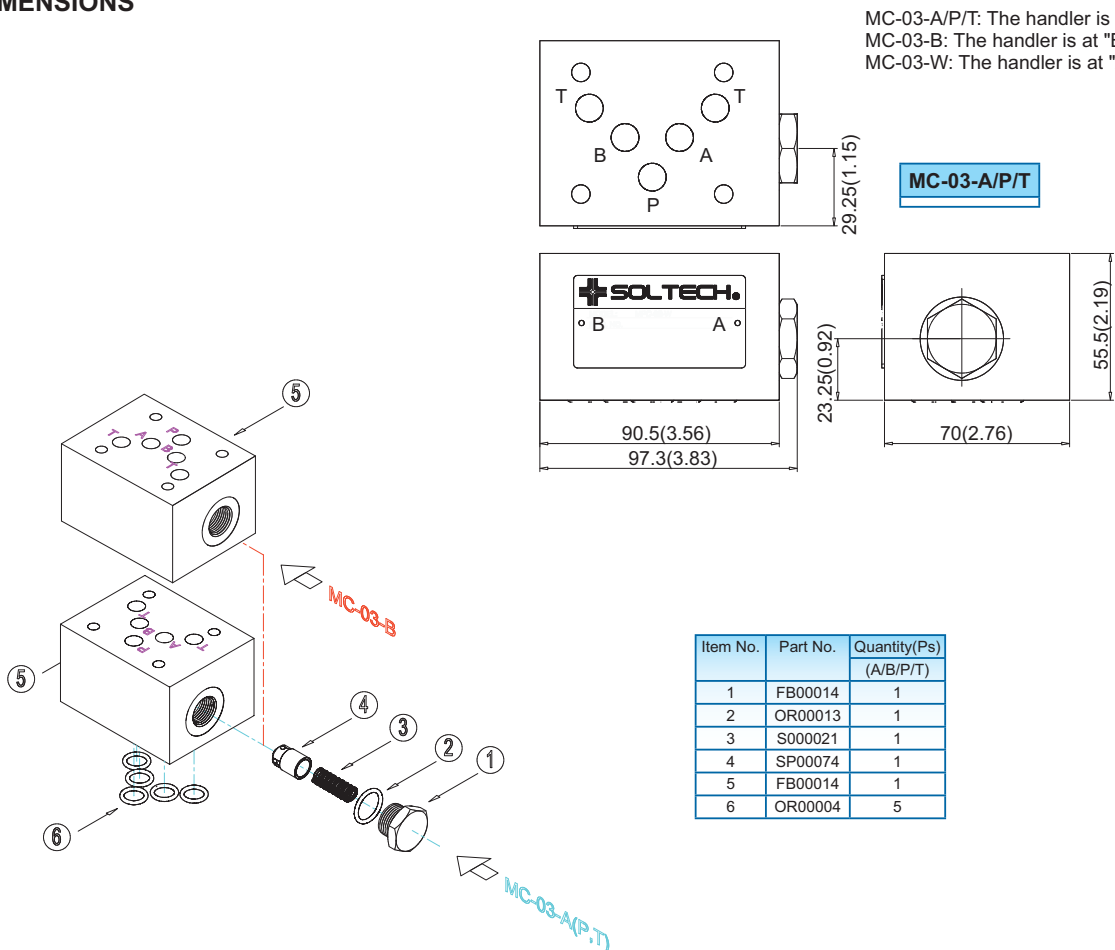

MC-03-A/P/T: The handler is at "A" side
MC-03-B: The handler is at "B" side
MC-03-W: The handler is at "A&B" side

Item No.	Part No.	Quantity(Ps)
		(A/B/P/T)
1	FB00014	1
2	OR00013	1
3	S000021	1
4	SP00074	1
5	FB00014	1
6	OR00004	5

UNIT: M.M.(INCH)

B



SOLTECH

MODULAR(STACK) CONTROLS

CHECK MODULAR VALVES

B

【MC-04】

ISO 4401-AD-07-4-A, CETOP 07, NG16, NFPA-D07

※SPECIFICATION

MODEL	MAX. OPER. PRES. Bar(PSI)	MAX. FLOW ℓ/min(U.S.GPM)	WEIGHT (Kg)
MC-04-P	210(3045)	190(50.2)	7.0
MC-04-A			
MC-04-B			
MC-04-T			

※GRAPHIC SYMBOL

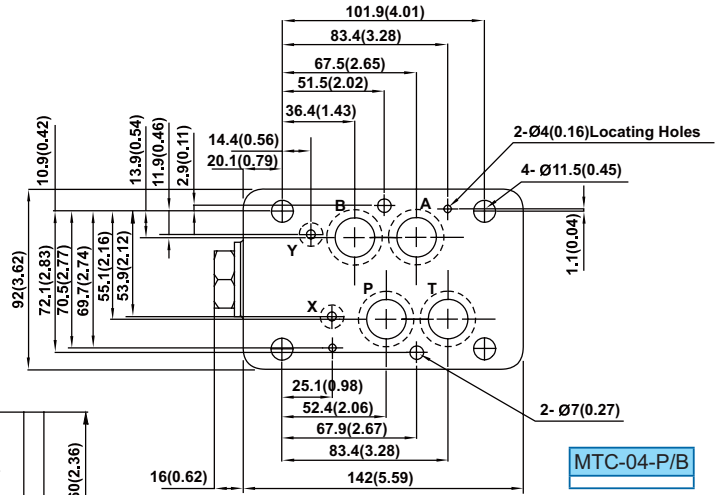
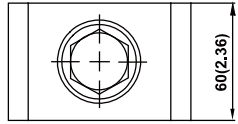
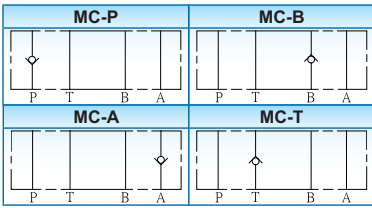

※MODEL NUMBER DESIGNATION

MC	04	P	1	(90)
SERIES NO.	VALVE SIZE 04: NG16	FUNCTION PORT P: "P" PORT A: "A" PORT B: "B" PORT T: "T" PORT	CRACKING PRESSURE (Kg/cm ²) 1: 0.5 2: 2.5 3: 4	OMIT: DIN 912 BOLTS 90: UNC BOLTS (NORTH AMERICA STD.)

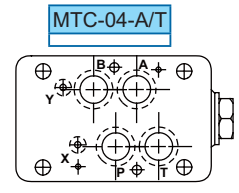

【MC-06】

ISO 4401-AE-08-4-A, CETOP 08, NG25, NFPA-D08

※SPECIFICATION

MODEL	MAX. OPER. PRES. Bar(PSI)	MAX. FLOW ℓ/min(U.S.GPM)	WEIGHT (Kg)
MC-06-P	210(3045)	300(79.3)	7.0
MC-06-A			
MC-06-B			
MC-06-T			

※GRAPHIC SYMBOL

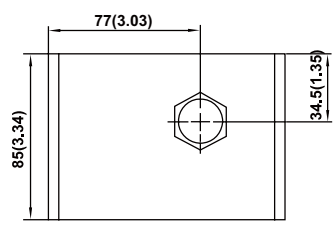
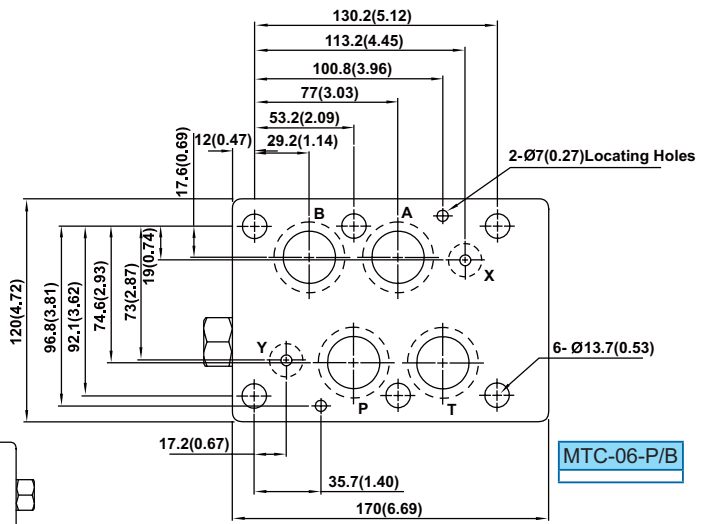
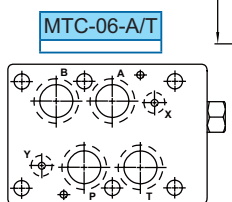
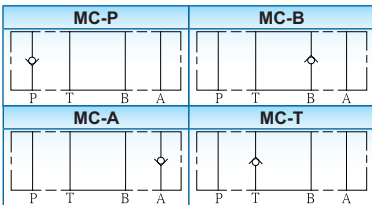

※MODEL NUMBER DESIGNATION

MC	04	P	1	(90)
SERIES NO.	VALVE SIZE 04: NG16	FUNCTION PORT P: "P" PORT A: "A" PORT B: "B" PORT T: "T" PORT	CRACKING PRESSURE (Kg/cm ²) 1: 0.5 2: 2.5 3: 4	OMIT: DIN 912 BOLTS 90: UNC BOLTS (NORTH AMERICA STD.)

UNIT: M.M.(INCH)